

# Shade Measuring Worksheet

## Single Roller and In-Line Coupled Shades

Date: \_\_\_\_\_  
 Project: \_\_\_\_\_  
 Name: \_\_\_\_\_

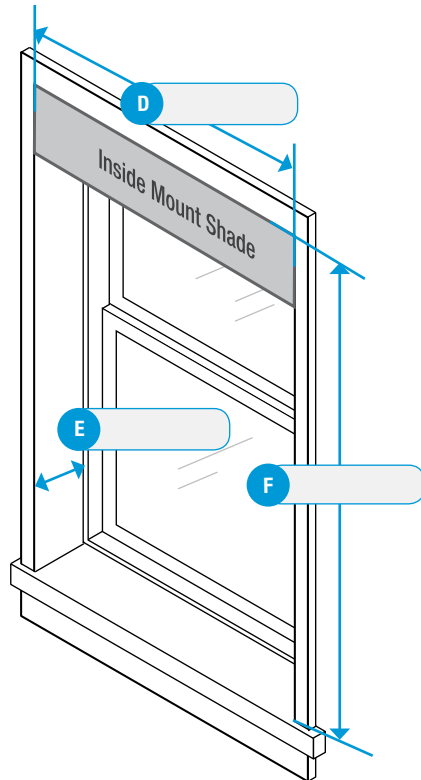
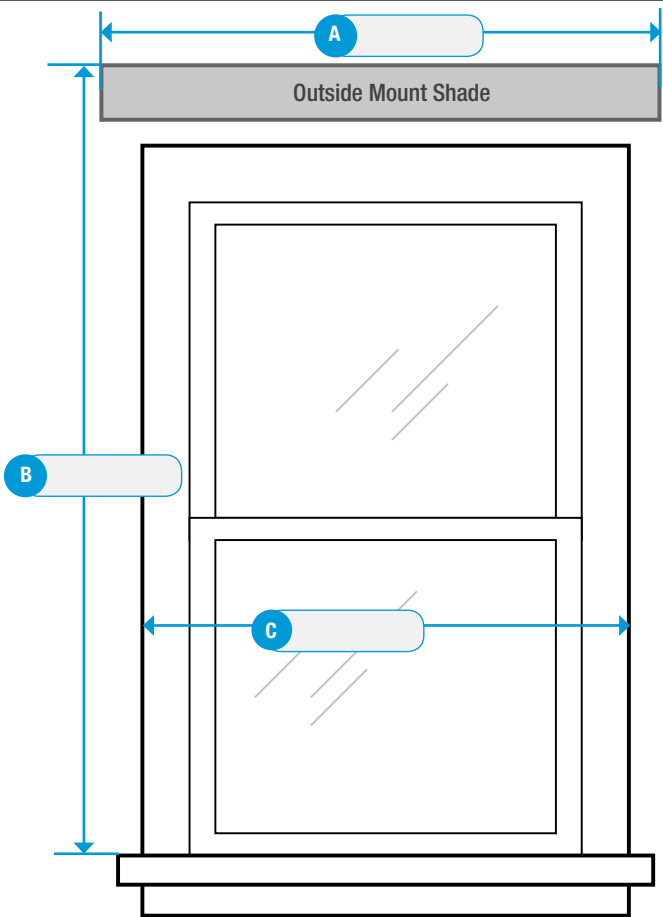

**Architectural**  
 CSS-ARCH3  
 CSS-ARCH5

**Decor**  
 CSS-DECOR3  
 CSS-DECOR5

Single Dual

- A** Outside Mount B2B
- B** Shade Height
- C** Total Width
- D** Inside Mount B2B
- E** Jamb Depth
- F** Inner Height

**NOTE:** For the inside mount (B2B) dimension, measure across the top, center, and bottom of the window, and then enter the smallest dimension. For the inner height dimension, measure the left, center, and right window height, and then enter the smallest value.

Sketch the room or window for obstructions and other details.

**INSTRUCTIONS:**

- Inspect the window and the area around the window for obstructions sticking out (knobs, sills, etc.) that may prevent the smooth travel of the shade.
- Verify the frame, sill, and header are level, and then measure all designations.
- Check the appropriate check boxes and enter the measurements.
- For in-line coupled shades use a new sheet for each band. Be sure to indicate the band location below.
- Use additional sheets as needed.

**Building:** \_\_\_\_\_ **Floor:** \_\_\_\_\_  
**Room:** \_\_\_\_\_ **Window/Door:** \_\_\_\_\_

**Shade Purpose:**       Transparent       Translucent       Room Darkening

**Fabric #:** \_\_\_\_\_

**Roll Direction:**       Regular       Reverse

**Drive/Clutch:**       Right       Left

**Fascia:**       None       Round       Square

**Top & Back Cover:**       Yes       No

**Color (Arch/Decor):**       White       Gray       Almond       Brown       Black

**Color (Decor only):**       Bright Chrome       Brushed Nickel       Antique Bronze

**Blackout:**       Side Channel       Sill Angle

**Drive Type:**       Manual Clutch       Motorized

**Communication:**       Cresnet<sup>®</sup> Control Network       inFINET EX<sup>®</sup> Wireless Gateway

**In-Line Coupled Shade:** Band \_\_\_\_\_ of \_\_\_\_\_ (sketch required)

**Notes:** \_\_\_\_\_

Crestron, the Crestron logo, Cresnet, and inFINET EX are either trademarks or registered trademarks of Crestron Electronics, Inc. in the United States and/or other countries. Other trademarks, registered trademarks, and trade names may be used in this document to refer to either the entities claiming the marks and names or their products. Crestron disclaims any proprietary interest in the marks and names of others. Crestron is not responsible for errors in typography or photography. ©2016 Crestron Electronics, Inc. Doc. 7925A (2047204) 08.16

